

INSTALLATION MANUAL

13603

Level of Difficulty

Moderate

Installation difficulty levels are based on time and effort involved and may vary depending on the installer level of expertise, condition of the vehicle and proper tools and equipment.

Weight Carrying Capacity

Gross trailer weight (GTW)	3,000 lbs.
Tongue weight (TW)	300 lbs.

Parts List

Item	Qty	Description
1	1	Trailer hitch
2	4	Hex bolt, M12 1.25, 60, CL 8.8
3	4	Conical-toothed washer, 1/2"
4	1	Hex bolt, M12 1.25, 30, CL 10.9
5	1	Tube spacer

Tools Required

Ratchet	Torque wrench
Socket, 10mm	Torque adaptor, 19mm
Socket, 14mm	Rotary tool
Socket, 19mm	Cut-off wheel

* For a tools reference guide visit curtmfg.com/trailer-hitch-installation

⚠ WARNING

Never exceed the vehicle manufacturer's recommended towing capacity.

Product Photo



NOTICE

Visit www.curtmfg.com for a full-color copy of this instruction manual, as well as helpful videos, guides and much more!

Before you begin installation, read all instructions thoroughly.

Proper tools will improve the quality of installation and reduce the time required.

This installation requires:

- Underbody panel trimming

Periodic inspection of the trailer hitch should be performed to ensure all mounting hardware remains tight and structural components are secure.

To help prevent damage to the product or vehicle, refer to the specified torque specifications when securing hardware during the installation process.

SAFETY INSTRUCTIONS

Safety glasses should be worn at all times while installing this product.

Product Registration and Warranty

CURT stands behind our products with industry-leading warranties. To get copies of the product warranties, register your purchase or provide feedback, visit: warranty.curtgroup.com/surveys

ASSEMBLY

Parts List

Item	Qty	Description
1	1	Trailer hitch
2	4	Hex bolt, M12 1.25, 60, CL 8.8
3	4	Conical-toothed washer, 1/2"
4	1	Hex bolt, M12 1.25, 30, CL 10.9
5	1	Tube spacer

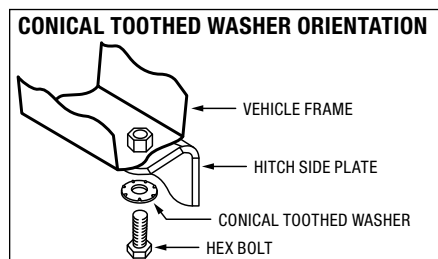
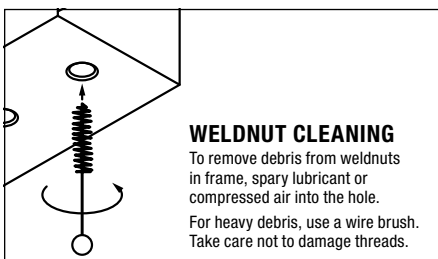
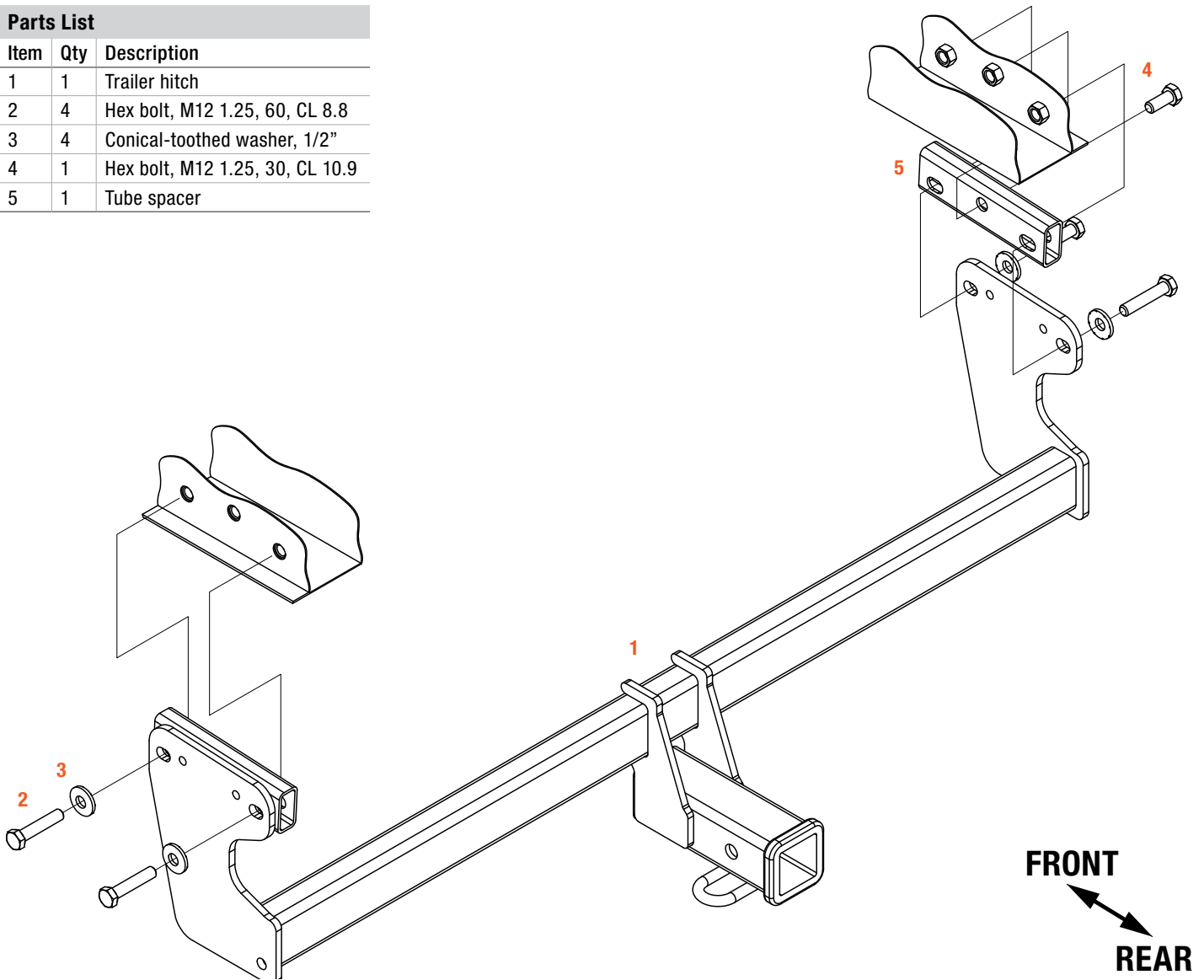

Step 1

Remove the rearmost underbody panel by removing six push fasteners and three nuts with a 10mm socket and one nut with a 14mm socket.

Trim the underbody panel using the rectangle guide to the right as shown.



Step 2

Relocate the electrical connector from the bumper cover to the side bracket.



Step 3

Install the tube spacer on the passenger-side frame rail by bolting the middle hole of the spacer using the short M12 hex bolt (#4) to the middle hole of the frame rail with the larger hole facing outwards.

Note: Temporarily installing a bolt into one of the remaining holes will help prevent the spacer from rotating when tightening.



Step 4

Raise the hitch, hooking the driver side over the lip of the frame rail and rotate the hitch into position. Loosely secure with remaining M12 bolts (#2) and conical-toothed washers (#3).



Step 5

Torque all M12 bolts to 60.2 ft-lbs.

If torque adapter is used, adjust the torque accordingly.

Reinstall the underbody panel.



Final Installed Image



TOWING BASICS & SAFETY INFORMATION

For information on safely towing your trailer, visit curtmfg.com/understanding-towing.