



**2020-2023 Sierra HD  
Mud Flap Set, Front  
Mounting Diagram & Instructions  
Kit# GCR200F**

**IMPORTANT:**

**Manufacturer is not responsible for negligent use of vehicle with mud flaps installed, including over-tightening of screws and bolts causing damage to vehicle or mud flaps.**

**TOOLS REQUIRED:**

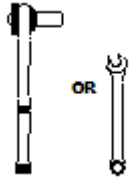

*1/4" Open Wrench or  
Socket Wrench*

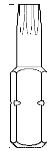

*T15 Torx  
Bit*

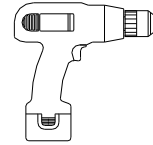

*Electric or Rechargeable  
Drill*

**FLAPS:**

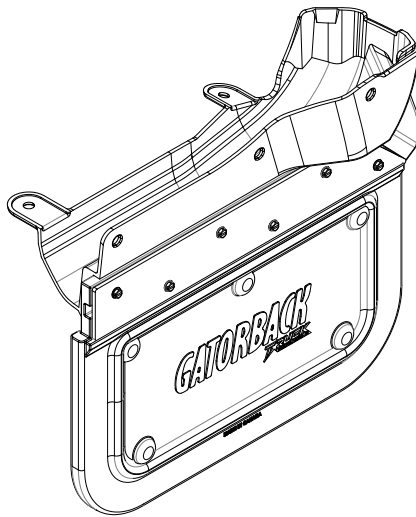

*(1) Flap Assy  
Front, DS*

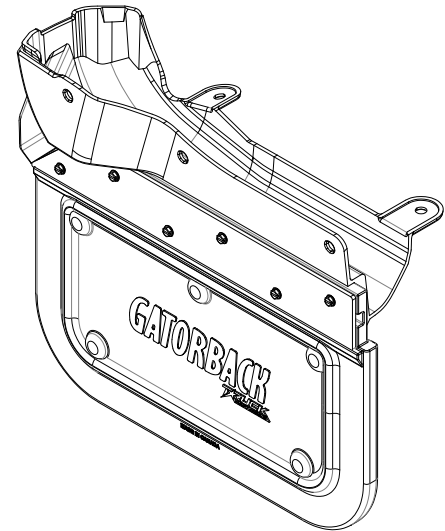

*(1) Flap Assy  
Front, PS*

**PARTS BAG #770710**

*a) (10) Screw, Sheet Metal  
#8-18 x 1", SS, Black Oxidized  
Part # 016055*



*b) (10) Washer, Flat  
0.203" x 0.781", SS, Black Oxidized  
Part # 018085*

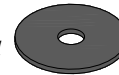

Please check out our YouTube channel to see an install video for this application.





## INSTALLATION *(For ease of installation it is suggested that the wheel be removed)*

1. Remove the 5 factory screws from the existing factory guard.
2. Gently pull the guard from the truck.
3. Position cap, ensuring the top lip of the cap slides under the fender molding.
4. Install the finishing cap to the factory holes using supplied screws and washers. Be careful not to overtighten.
5. Repeat procedure on passenger side.

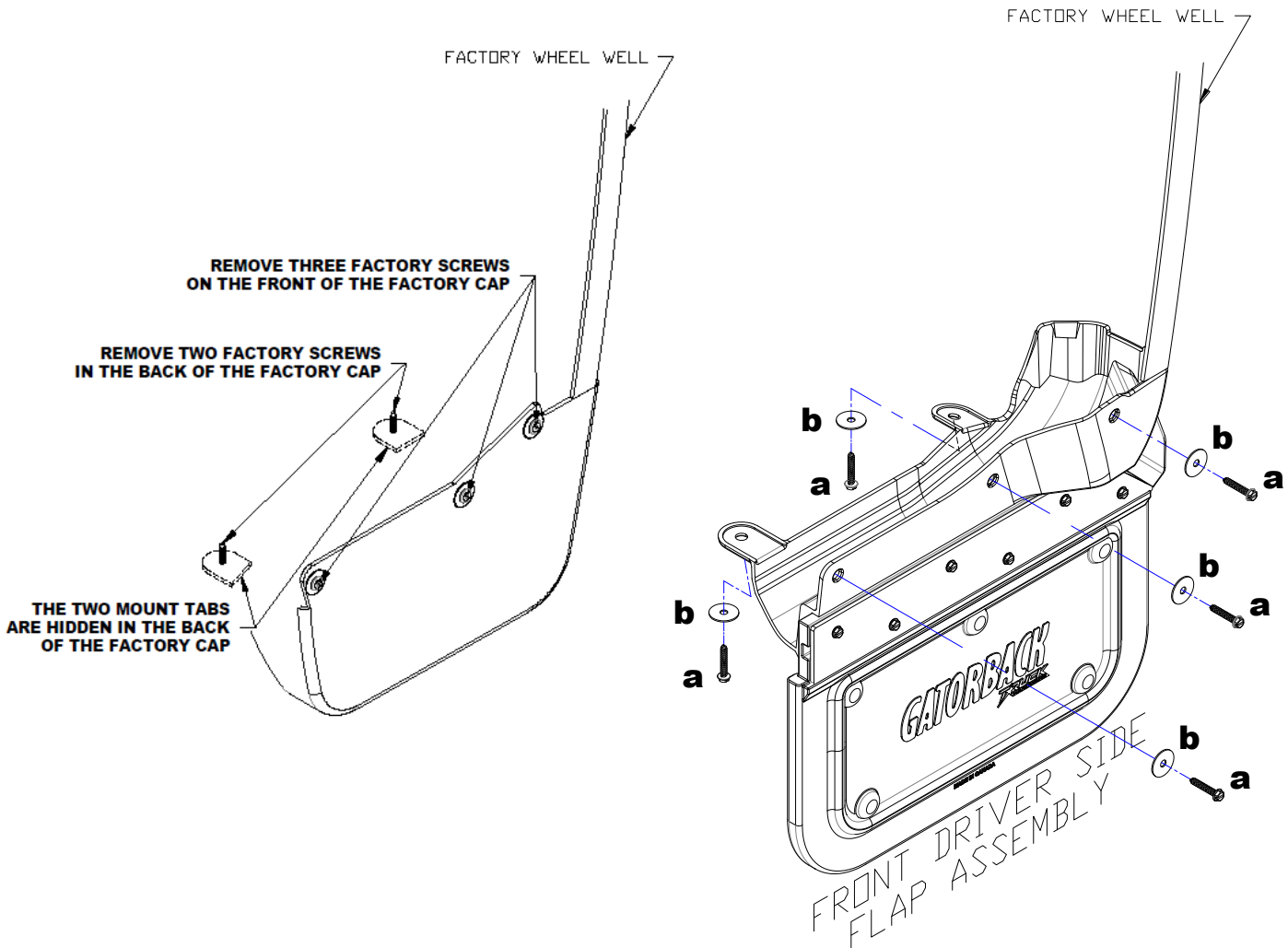

Please check out our YouTube channel to see an install video for this application.





**2020-2023 Sierra HD  
Mud Flap Set, Rear  
Mounting Diagram & Instructions  
Kit# GCR200R**

**TO BE USED WITH SILVERADO CAP PART #FC004R**

**IMPORTANT:**

*Manufacturer is not responsible for negligent use of vehicle with mud flaps installed, including over-tightening of screws and bolts causing damage to vehicle or mud flaps.*

**TOOLS REQUIRED-**

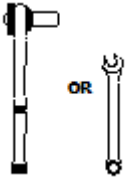

7/16" Open Wrench or  
Socket Wrench

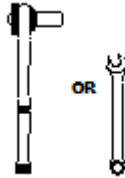

1/4" Open Wrench or  
Socket Wrench



T15 Torx  
Bit

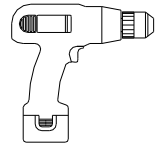

Electric or Rechargeable  
Drill

**FLAPS**

(1) Flap Assy  
Rear, DS

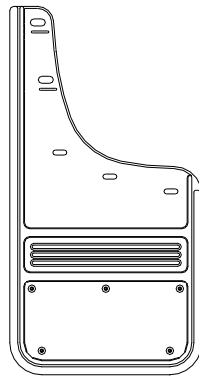

(1) Flap Assy  
Rear, PS

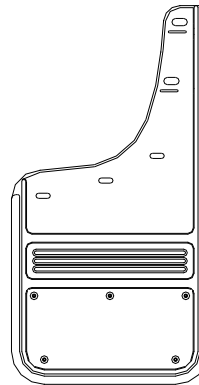

**PARTS BAG #770667**

a) (4) Capscrew, Blk Ox  
1/4"-20UNC x 3/4"  
Part # 014070

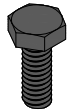

b) (6) Screw, Blk Ox.  
1/4" Hex Head, #8-18x1.5"  
Part #016063



c) (6) Washer, Flat  
0.203" x 1.5" SS Blk Ox  
Part #018080

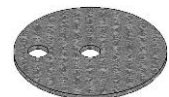

d) (4) Washer, Flat  
0.281" x 1.5" Blk Ox.  
Part #018084



e) (2) Mud Flap Clip  
Driver Side  
Part # 769312

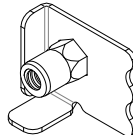

f) (2) Mud Flap Clip  
Passenger Side  
Part #769313

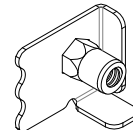

**For Finishing Cap Installation:**

g) (4) Screw, Blk Ox.  
1/4" Hex Head, #8-18x1"  
Part #016055



h) (4) Washer, Flat  
0.203" x 0.781" Blk Ox.  
Part #018085



## FINISHING CAPS FC004R:

(1) Finishing Cap  
Driver's Side

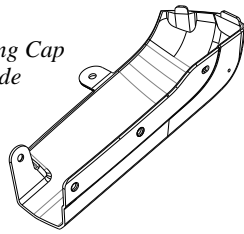

(1) Finishing Cap  
Passenger's Side

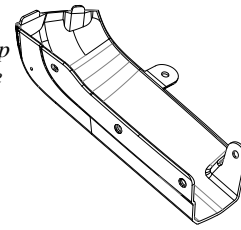

## INSTALLATION *(For ease of installation it is suggested that the wheel be removed)*

### CAPS:

1. Remove the 5 factory screws from the existing factory guard.
2. Gently pull the guard from the truck.
3. Position cap, ensuring the top lip of the cap slides under the fender molding as shown.
4. Install the underside and back of the finishing cap to the factory holes using a screw (g) and flat washer (h). Be careful not to overtighten.
5. Repeat procedure on passenger side.

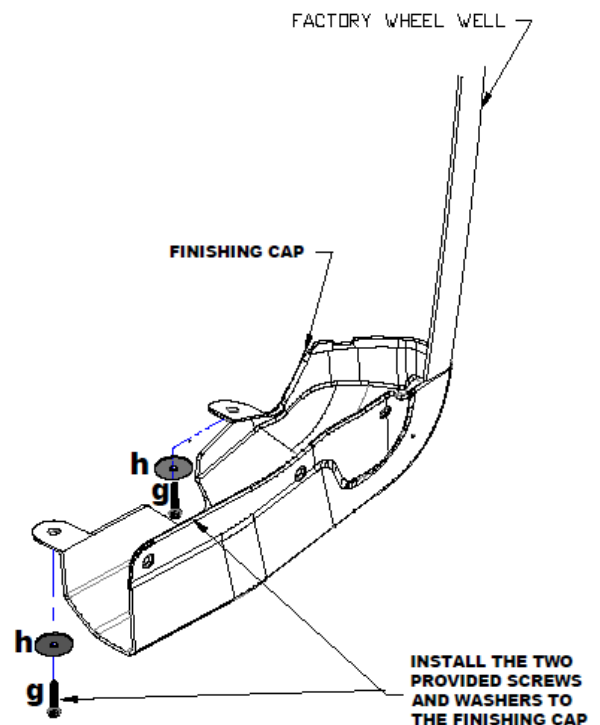
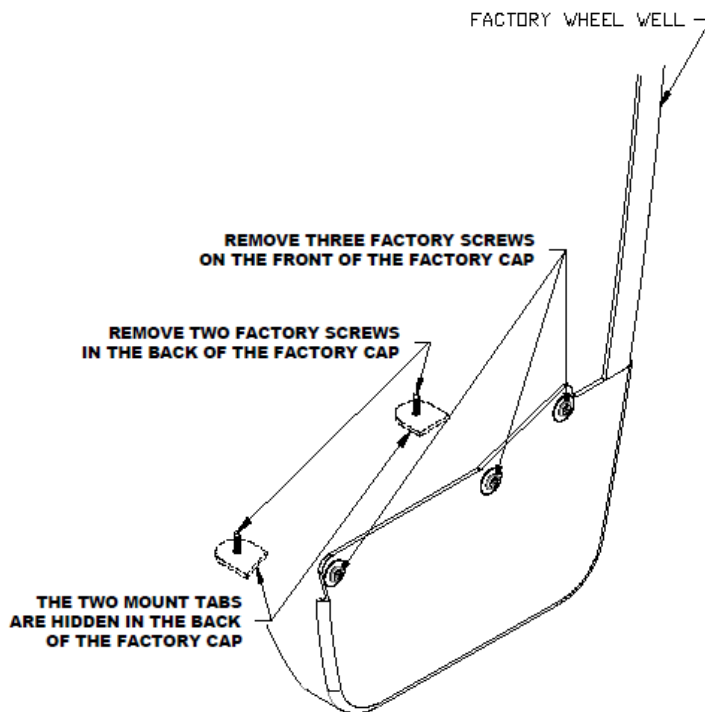

\*Universal Instructions: Diagram of parts may vary due to application differences.

Please check out our YouTube channel to see an install video for this application.



## MUD FLAPS:

1. Before you install your Mud Flap Set, see the diagram and parts list for all necessary parts. Start on the driver's side.
2. Loosely install mount clip (e) to mud flap holes #1 & #2 using a cap screw (a) and flat washer (d)
3. Loosely secure mud flap hole #3 to finishing cap hole #6 using screw (b) and flat washer (c)
4. Secure mount clips (e) on holes #1 & #2 behind fender lip. \*Note\* Ensure all factory holes line up with finishing cap holes.
5. Secure mud flap through holes #4 & #5 into finishing cap hole #7 & #8 using supplied screw (b), and washer (c).
6. Using a bubble level or other levelling tool, ensure that the mud flap is level. Tighten fasteners, being careful not to overtighten.
7. Repeat procedure for passenger side.

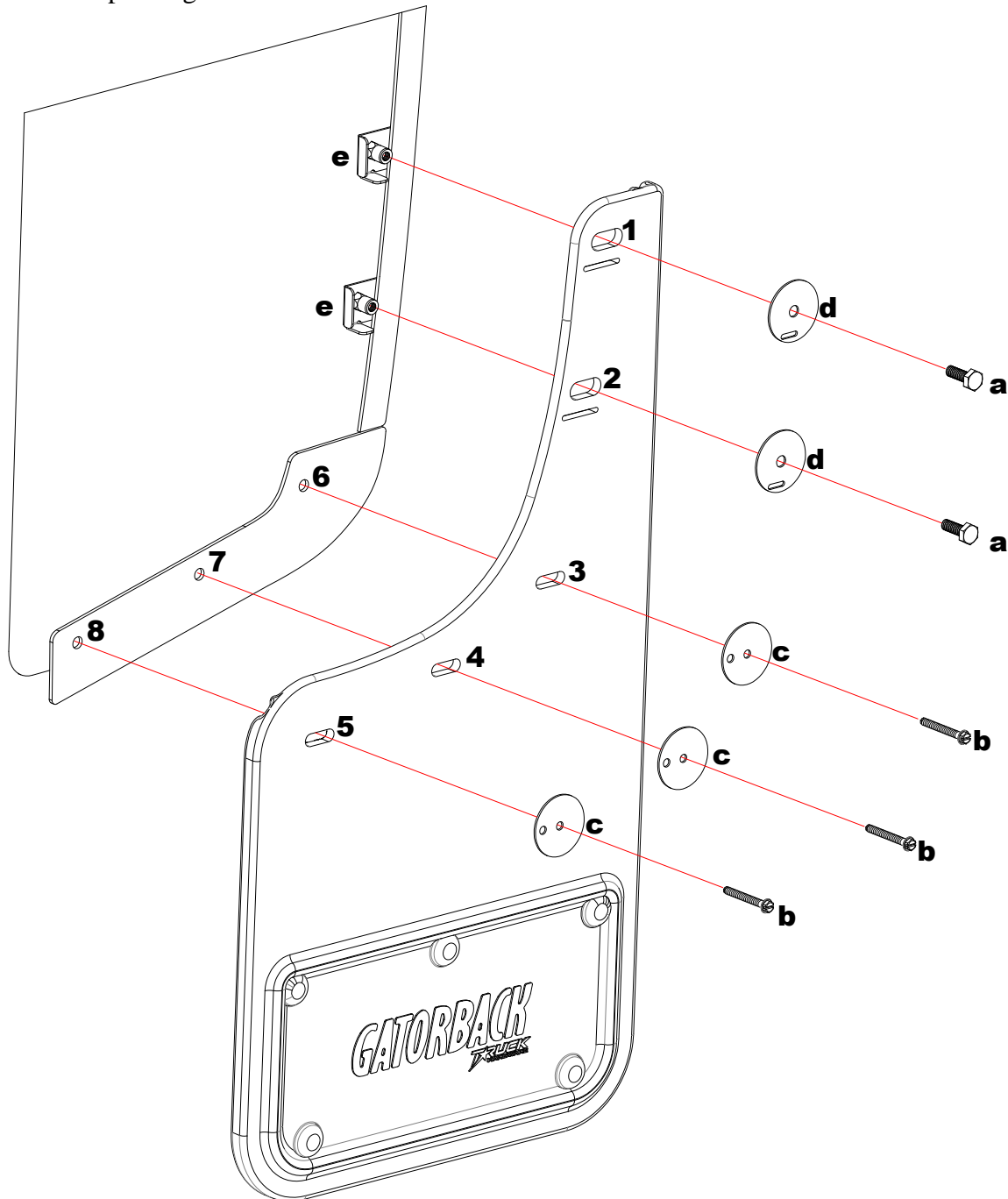

Please check out our YouTube channel to see an install video for this application.



Sierra Rear